

KM45 Standard Type

A type : A single carriage-nut with standard length
 B type : Two carriage-nuts with standard length

KM45 Cover Type

A type : A single carriage-nut with standard length
 B type : Two carriage-nuts with standard length

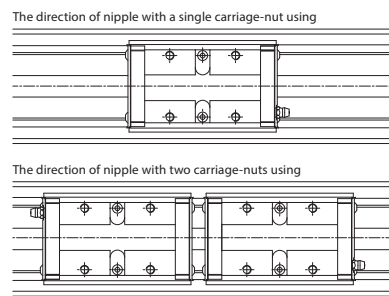
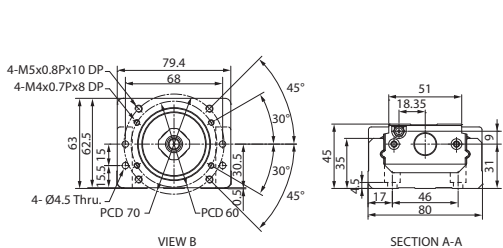
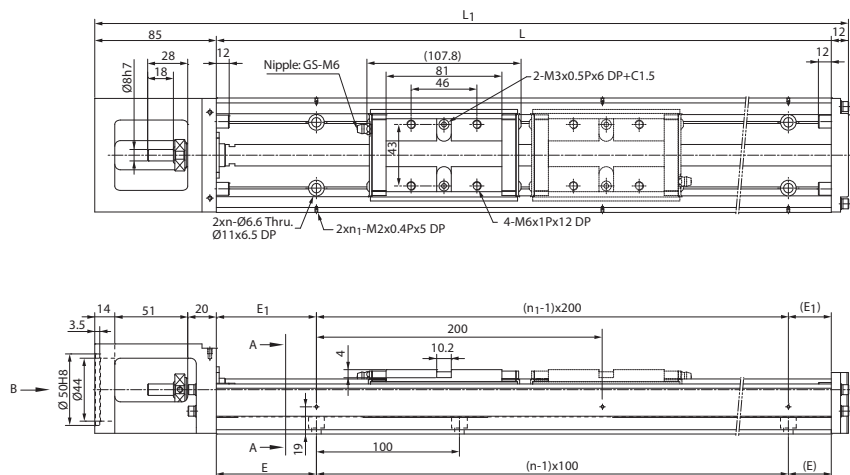

Unit : mm

Rail Length L	Overall Length L ₁	Max. Stroke		E	n	E ₁	n ₁	Weight (kg)	
		A Type	B Type					A Type	B Type
		340	437					190	80
440	537	290	180	70	4	20	3	8.07	9.27
540	637	390	280	70	5	70	3	9.37	10.57
640	737	490	380	70	6	20	4	10.68	11.88
740	837	590	480	70	7	70	4	12.08	13.28
840	937	690	580	70	8	20	5	13.2	14.4
940	1037	790	680	70	9	70	5	14.37	15.57

Note*: The max. stroke of B type is based on two carriage-nuts used in closed contact with each other.

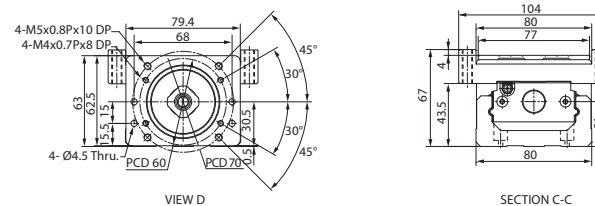
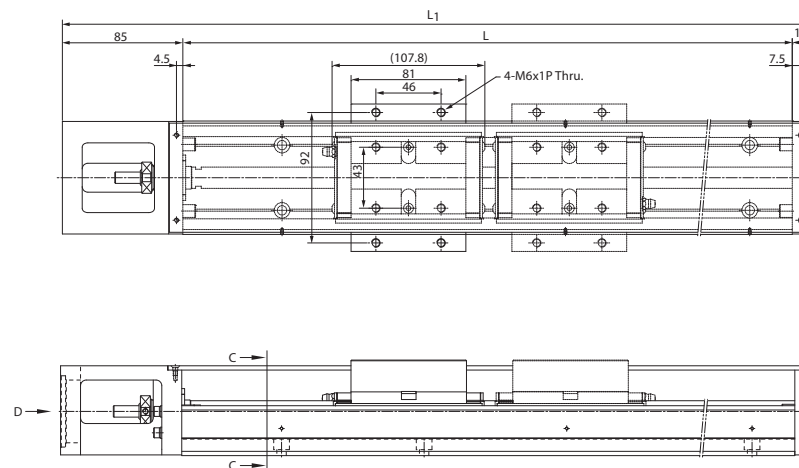

Unit : mm

Rail Length L	Overall Length L ₁	Max. Stroke		Weight (kg)	
		A Type	B Type	A Type	B Type
		340	437	190	80
440	537	290	180	8.67	10.07
540	637	390	280	9.97	11.37
640	737	490	380	11.28	12.68
740	837	590	480	12.68	14.08
840	937	690	580	13.78	15.18
940	1037	790	680	14.97	16.37

Note*: The max. stroke of B type is based on two carriage-nuts used in closed contact with each other.